

**View - Deformation, Exact deformation(s), Cases: 1 (DL1)**

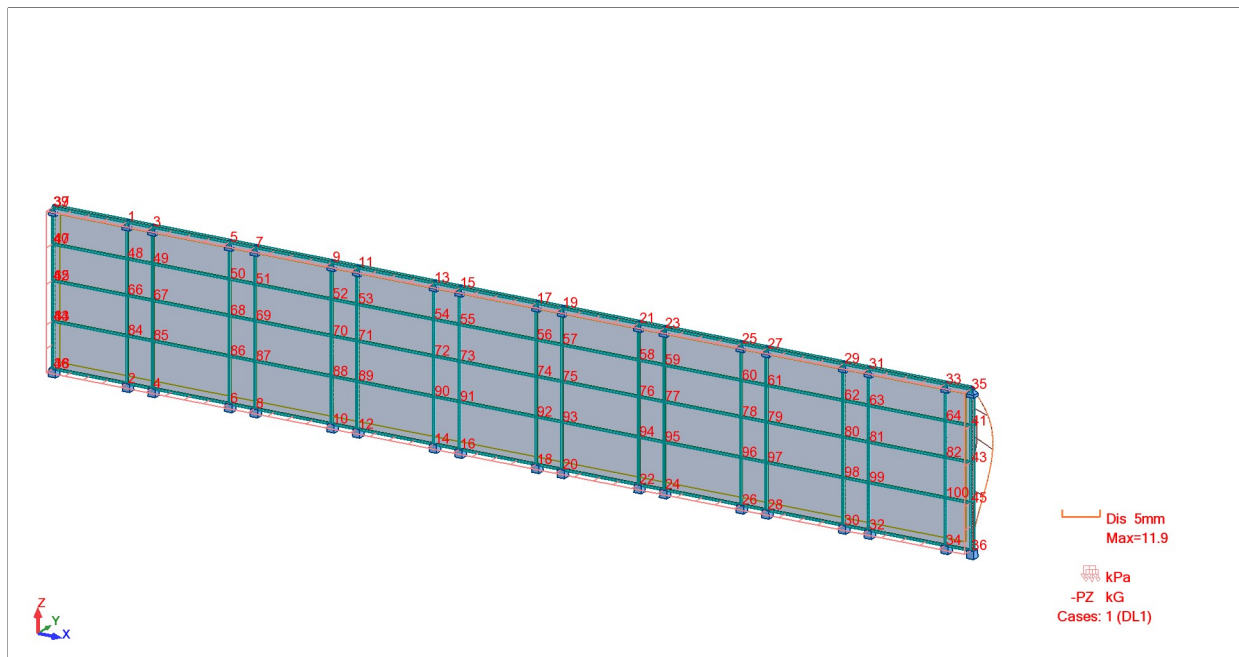

**View - S max,S min, Cases: 1 (DL1)**

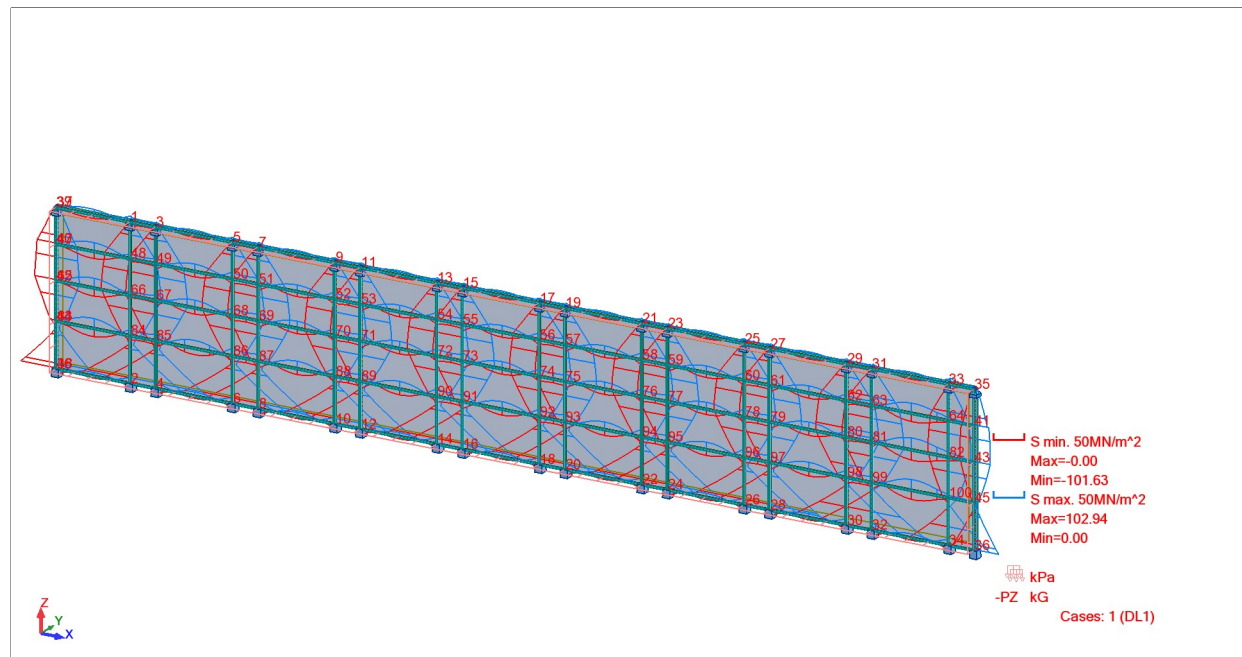

**View - Reaction moments(kN\*m,kN\*m/m), Cases: 1 (DL1)**

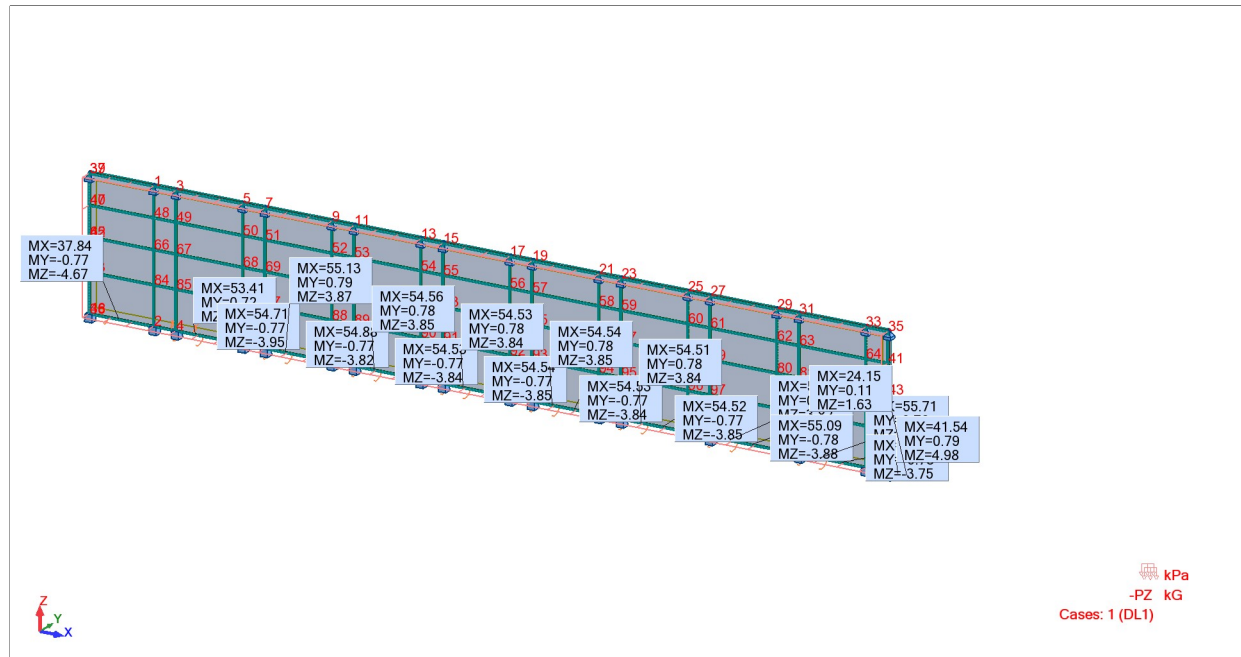

# **TITLE PAGE**

**Project: Zaluri elenentis angarishi**

**Author :**

**Reactions ULS: global extremes**

in the coordinate system: global - Case: 1 (DL1)

	FX (kN)	FY (kN)	FZ (kN)	MX (kNm)
<b>MAX</b>	0.48	-2.67	8.05	55.71
<b>Node</b>	5	35	33	30
<b>Case</b>	1	1	1	1
<b>MIN</b>	-0.63	-33.05	3.02	-0.00
<b>Node</b>	37	32	35	15
<b>Case</b>	1	1	1	1

	MY (kNm)	MZ (kNm)
<b>MAX</b>	0.79	4.98
<b>Node</b>	34	34
<b>Case</b>	1	1
<b>MIN</b>	-0.78	-4.67
<b>Node</b>	32	38
<b>Case</b>	1	1

**Displacements SLS: global extremes**

- Case: 1 (DL1)

	UX (mm)	UY (mm)	UZ (mm)	RX (Rad)
<b>MAX</b>	0.0	11.4	0.0	0.005
<b>Node</b>	100	80	39	29
<b>Case</b>	1	1	1	1
<b>MIN</b>	-0.0	-0.0	-0.0	-0.003
<b>Node</b>	44	39	82	98
<b>Case</b>	1	1	1	1

	RY (Rad)	RZ (Rad)
<b>MAX</b>	0.000	0.001
<b>Node</b>	37	42
<b>Case</b>	1	1

	<b>RY (Rad)</b>	<b>RZ (Rad)</b>
<b>MIN</b>	-0.000	-0.002
<b>Node</b>	25	43
<b>Case</b>	1	1

**Member Forces ULS: envelope****- Case: 1 (DL1)**

<b>Bar</b>	<b>FX (kN)</b>	<b>FY (kN)</b>	<b>FZ (kN)</b>	<b>MX (kNm)</b>
<b>26 / MAX</b>	0.0	0.00	-0.00	0.00
<b>Node</b>	39	39	39	39
<b>Case</b>	1	1	1	1
<b>26 / MIN</b>	0.0	0.00	-0.01	0.00
<b>Node</b>	39	39	37	39
<b>Case</b>	1	1	1	1
<b>27 / MAX</b>	0.0	4.35	1.26	-0.89
<b>Node</b>	37	1	37	37
<b>Case</b>	1	1	1	1
<b>27 / MIN</b>	0.0	-2.27	-1.33	-0.89
<b>Node</b>	37	37	1	37
<b>Case</b>	1	1	1	1
<b>28 / MAX</b>	0.0	0.15	0.43	-0.34
<b>Node</b>	1	3	1	1
<b>Case</b>	1	1	1	1
<b>28 / MIN</b>	0.0	-0.98	-0.47	-0.34
<b>Node</b>	1	1	3	1
<b>Case</b>	1	1	1	1
<b>29 / MAX</b>	0.0	3.51	1.34	-0.05
<b>Node</b>	3	5	3	3
<b>Case</b>	1	1	1	1
<b>29 / MIN</b>	0.0	-3.43	-1.35	-0.05
<b>Node</b>	3	3	5	3
<b>Case</b>	1	1	1	1
<b>30 / MAX</b>	0.0	0.48	0.44	0.03
<b>Node</b>	5	7	5	5
<b>Case</b>	1	1	1	1
<b>30 / MIN</b>	0.0	-0.64	-0.46	0.03
<b>Node</b>	5	5	7	5
<b>Case</b>	1	1	1	1
<b>31 / MAX</b>	0.0	3.47	1.34	0.02
<b>Node</b>	7	9	7	7
<b>Case</b>	1	1	1	1
<b>31 / MIN</b>	0.0	-3.47	-1.35	0.02
<b>Node</b>	7	7	9	7
<b>Case</b>	1	1	1	1
<b>32 / MAX</b>	0.0	0.55	0.44	0.01

Bar	FX (kN)	FY (kN)	FZ (kN)	MX (kNm)
<b>Node</b>	9	11	9	9
<b>Case</b>	1	1	1	1
<b>32 / MIN</b>	0.0	-0.57	-0.46	0.01
<b>Node</b>	9	9	11	9
<b>Case</b>	1	1	1	1
<b>33 / MAX</b>	0.0	3.47	1.34	0.00
<b>Node</b>	11	13	11	11
<b>Case</b>	1	1	1	1
<b>33 / MIN</b>	0.0	-3.47	-1.34	0.00
<b>Node</b>	11	11	13	11
<b>Case</b>	1	1	1	1
<b>34 / MAX</b>	0.0	0.56	0.44	-0.00
<b>Node</b>	13	15	13	13
<b>Case</b>	1	1	1	1
<b>34 / MIN</b>	0.0	-0.56	-0.46	-0.00
<b>Node</b>	13	13	15	13
<b>Case</b>	1	1	1	1
<b>35 / MAX</b>	0.0	3.47	1.34	-0.00
<b>Node</b>	15	17	15	15
<b>Case</b>	1	1	1	1
<b>35 / MIN</b>	0.0	-3.47	-1.34	-0.00
<b>Node</b>	15	15	17	15
<b>Case</b>	1	1	1	1
<b>36 / MAX</b>	0.0	0.56	0.44	0.00
<b>Node</b>	17	19	17	17
<b>Case</b>	1	1	1	1
<b>36 / MIN</b>	0.0	-0.56	-0.45	0.00
<b>Node</b>	17	17	19	17
<b>Case</b>	1	1	1	1
<b>37 / MAX</b>	0.0	3.47	1.34	0.00
<b>Node</b>	19	21	19	19
<b>Case</b>	1	1	1	1
<b>37 / MIN</b>	0.0	-3.47	-1.34	0.00
<b>Node</b>	19	19	21	19
<b>Case</b>	1	1	1	1
<b>38 / MAX</b>	0.0	0.56	0.44	-0.00
<b>Node</b>	21	23	21	21
<b>Case</b>	1	1	1	1
<b>38 / MIN</b>	0.0	-0.56	-0.45	-0.00
<b>Node</b>	21	21	23	21
<b>Case</b>	1	1	1	1
<b>39 / MAX</b>	0.0	3.47	1.34	-0.02
<b>Node</b>	23	25	23	23
<b>Case</b>	1	1	1	1
<b>39 / MIN</b>	0.0	-3.47	-1.34	-0.02
<b>Node</b>	23	23	25	23

Bar	FX (kN)	FY (kN)	FZ (kN)	MX (kNm)
Case	1	1	1	1
40 / MAX	0.0	0.61	0.44	-0.05
Node	25	27	25	25
Case	1	1	1	1
40 / MIN	0.0	-0.51	-0.45	-0.05
Node	25	25	27	25
Case	1	1	1	1
41 / MAX	0.0	3.48	1.34	-0.02
Node	27	29	27	27
Case	1	1	1	1
41 / MIN	0.0	-3.46	-1.34	-0.02
Node	27	27	29	27
Case	1	1	1	1
42 / MAX	0.0	0.33	0.45	0.22
Node	29	31	29	29
Case	1	1	1	1
42 / MIN	0.0	-0.79	-0.45	0.22
Node	29	29	31	29
Case	1	1	1	1
43 / MAX	0.0	3.50	1.33	0.98
Node	31	33	31	31
Case	1	1	1	1
43 / MIN	0.0	-3.44	-1.36	0.98
Node	31	31	33	31
Case	1	1	1	1
44 / MAX	0.0	-3.63	0.82	2.14
Node	33	35	33	33
Case	1	1	1	1
44 / MIN	0.0	-4.76	-0.07	2.14
Node	33	33	35	33
Case	1	1	1	1
45 / MAX	-0.00	0.00	0.00	-0.00
Node	40	40	40	40
Case	1	1	1	1
45 / MIN	-0.00	0.00	-0.01	-0.00
Node	40	40	47	40
Case	1	1	1	1
46 / MAX	-0.24	7.10	1.29	-0.59
Node	47	48	47	47
Case	1	1	1	1
46 / MIN	-0.24	-6.13	-1.30	-0.59
Node	47	47	48	47
Case	1	1	1	1
47 / MAX	-0.07	1.35	0.43	-0.22
Node	48	49	48	48
Case	1	1	1	1



Bar	FX (kN)	FY (kN)	FZ (kN)	MX (kNm)
<b>47 / MIN</b>	-0.07	-0.90	-0.47	-0.22
Node	48	48	49	48
Case	1	1	1	1
<b>48 / MAX</b>	-0.19	7.17	1.34	-0.03
Node	49	50	49	49
Case	1	1	1	1
<b>48 / MIN</b>	-0.19	-6.71	-1.34	-0.03
Node	49	49	50	49
Case	1	1	1	1
<b>49 / MAX</b>	-0.03	1.19	0.44	0.03
Node	50	51	50	50
Case	1	1	1	1
<b>49 / MIN</b>	-0.03	-1.06	-0.45	0.03
Node	50	50	51	50
Case	1	1	1	1
<b>50 / MAX</b>	-0.16	6.93	1.34	0.01
Node	51	52	51	51
Case	1	1	1	1
<b>50 / MIN</b>	-0.16	-6.94	-1.34	0.01
Node	51	51	52	51
Case	1	1	1	1
<b>51 / MAX</b>	-0.00	1.12	0.44	0.00
Node	52	53	52	52
Case	1	1	1	1
<b>51 / MIN</b>	-0.00	-1.13	-0.45	0.00
Node	52	52	53	52
Case	1	1	1	1
<b>52 / MAX</b>	-0.13	6.93	1.34	0.00
Node	53	54	53	53
Case	1	1	1	1
<b>52 / MIN</b>	-0.13	-6.94	-1.34	0.00
Node	53	53	54	53
Case	1	1	1	1
<b>53 / MAX</b>	0.02	1.12	0.44	-0.00
Node	54	55	54	54
Case	1	1	1	1
<b>53 / MIN</b>	0.02	-1.13	-0.45	-0.00
Node	54	54	55	54
Case	1	1	1	1
<b>54 / MAX</b>	-0.11	6.94	1.34	-0.00
Node	55	56	55	55
Case	1	1	1	1
<b>54 / MIN</b>	-0.11	-6.94	-1.34	-0.00
Node	55	55	56	55
Case	1	1	1	1
<b>55 / MAX</b>	0.04	1.13	0.44	0.00

Bar	FX (kN)	FY (kN)	FZ (kN)	MX (kNm)
<b>Node</b>	56	57	56	56
<b>Case</b>	1	1	1	1
<b>55 / MIN</b>	0.04	-1.12	-0.45	0.00
<b>Node</b>	56	56	57	56
<b>Case</b>	1	1	1	1
<b>56 / MAX</b>	-0.10	6.94	1.34	0.00
<b>Node</b>	57	58	57	57
<b>Case</b>	1	1	1	1
<b>56 / MIN</b>	-0.10	-6.93	-1.34	0.00
<b>Node</b>	57	57	58	57
<b>Case</b>	1	1	1	1
<b>57 / MAX</b>	0.05	1.14	0.44	-0.00
<b>Node</b>	58	59	58	58
<b>Case</b>	1	1	1	1
<b>57 / MIN</b>	0.05	-1.11	-0.45	-0.00
<b>Node</b>	58	58	59	58
<b>Case</b>	1	1	1	1
<b>58 / MAX</b>	-0.08	6.96	1.34	-0.01
<b>Node</b>	59	60	59	59
<b>Case</b>	1	1	1	1
<b>58 / MIN</b>	-0.08	-6.92	-1.34	-0.01
<b>Node</b>	59	59	60	59
<b>Case</b>	1	1	1	1
<b>59 / MAX</b>	0.06	1.09	0.44	-0.04
<b>Node</b>	60	61	60	60
<b>Case</b>	1	1	1	1
<b>59 / MIN</b>	0.06	-1.16	-0.45	-0.04
<b>Node</b>	60	60	61	60
<b>Case</b>	1	1	1	1
<b>60 / MAX</b>	-0.07	6.73	1.34	-0.02
<b>Node</b>	61	62	61	61
<b>Case</b>	1	1	1	1
<b>60 / MIN</b>	-0.07	-7.14	-1.34	-0.02
<b>Node</b>	61	61	62	61
<b>Case</b>	1	1	1	1
<b>61 / MAX</b>	0.07	0.67	0.44	0.11
<b>Node</b>	62	63	62	62
<b>Case</b>	1	1	1	1
<b>61 / MIN</b>	0.07	-1.58	-0.45	0.11
<b>Node</b>	62	62	63	62
<b>Case</b>	1	1	1	1
<b>62 / MAX</b>	-0.06	6.28	1.34	0.64
<b>Node</b>	63	64	63	63
<b>Case</b>	1	1	1	1
<b>62 / MIN</b>	-0.06	-7.60	-1.35	0.64
<b>Node</b>	63	63	64	63

Bar	FX (kN)	FY (kN)	FZ (kN)	MX (kNm)
Case	1	1	1	1
63 / MAX	0.04	2.78	0.66	1.51
Node	64	41	64	64
Case	1	1	1	1
63 / MIN	0.04	0.53	-0.23	1.51
Node	64	64	41	64
Case	1	1	1	1
64 / MAX	-0.00	-0.00	-0.00	-0.00
Node	42	42	42	42
Case	1	1	1	1
64 / MIN	-0.00	-0.00	-0.01	-0.00
Node	42	42	65	42
Case	1	1	1	1
65 / MAX	0.04	7.19	1.28	0.07
Node	65	66	65	65
Case	1	1	1	1
65 / MIN	0.04	-6.51	-1.31	0.07
Node	65	65	66	65
Case	1	1	1	1
66 / MAX	0.00	1.62	0.44	0.05
Node	66	67	66	66
Case	1	1	1	1
66 / MIN	0.00	-0.63	-0.46	0.05
Node	66	66	67	66
Case	1	1	1	1
67 / MAX	0.00	7.49	1.34	0.01
Node	67	68	67	67
Case	1	1	1	1
67 / MIN	0.00	-6.88	-1.34	0.01
Node	67	67	68	67
Case	1	1	1	1
68 / MAX	-0.02	1.22	0.45	-0.00
Node	68	69	68	68
Case	1	1	1	1
68 / MIN	-0.02	-1.03	-0.45	-0.00
Node	68	68	69	68
Case	1	1	1	1
69 / MAX	-0.02	7.18	1.34	-0.00
Node	69	70	69	69
Case	1	1	1	1
69 / MIN	-0.02	-7.20	-1.34	-0.00
Node	69	69	70	69
Case	1	1	1	1
70 / MAX	-0.03	1.11	0.45	-0.00
Node	70	71	70	70
Case	1	1	1	1

Bar	FX (kN)	FY (kN)	FZ (kN)	MX (kNm)
<b>70 / MIN</b>	-0.03	-1.14	-0.45	-0.00
Node	70	70	71	70
Case	1	1	1	1
<b>71 / MAX</b>	-0.03	7.18	1.34	-0.00
Node	71	72	71	71
Case	1	1	1	1
<b>71 / MIN</b>	-0.03	-7.19	-1.34	-0.00
Node	71	71	72	71
Case	1	1	1	1
<b>72 / MAX</b>	-0.04	1.12	0.45	0.00
Node	72	73	72	72
Case	1	1	1	1
<b>72 / MIN</b>	-0.04	-1.13	-0.45	0.00
Node	72	72	73	72
Case	1	1	1	1
<b>73 / MAX</b>	-0.04	7.19	1.34	-0.00
Node	73	74	73	73
Case	1	1	1	1
<b>73 / MIN</b>	-0.04	-7.19	-1.34	-0.00
Node	73	73	74	73
Case	1	1	1	1
<b>74 / MAX</b>	-0.05	1.13	0.45	-0.00
Node	74	75	74	74
Case	1	1	1	1
<b>74 / MIN</b>	-0.05	-1.12	-0.45	-0.00
Node	74	74	75	74
Case	1	1	1	1
<b>75 / MAX</b>	-0.04	7.19	1.34	-0.00
Node	75	76	75	75
Case	1	1	1	1
<b>75 / MIN</b>	-0.04	-7.18	-1.34	-0.00
Node	75	75	76	75
Case	1	1	1	1
<b>76 / MAX</b>	-0.05	1.14	0.45	0.00
Node	76	77	76	76
Case	1	1	1	1
<b>76 / MIN</b>	-0.05	-1.11	-0.45	0.00
Node	76	76	77	76
Case	1	1	1	1
<b>77 / MAX</b>	-0.04	7.21	1.34	0.00
Node	77	78	77	77
Case	1	1	1	1
<b>77 / MIN</b>	-0.04	-7.16	-1.34	0.00
Node	77	77	78	77
Case	1	1	1	1
<b>78 / MAX</b>	-0.05	1.07	0.45	0.01

Bar	FX (kN)	FY (kN)	FZ (kN)	MX (kNm)
<b>Node</b>	78	79	78	78
<b>Case</b>	1	1	1	1
<b>78 / MIN</b>	-0.05	-1.18	-0.45	0.01
<b>Node</b>	78	78	79	78
<b>Case</b>	1	1	1	1
<b>79 / MAX</b>	-0.03	6.95	1.34	-0.00
<b>Node</b>	79	80	79	79
<b>Case</b>	1	1	1	1
<b>79 / MIN</b>	-0.03	-7.43	-1.34	-0.00
<b>Node</b>	79	79	80	79
<b>Case</b>	1	1	1	1
<b>80 / MAX</b>	-0.04	0.42	0.45	-0.06
<b>Node</b>	80	81	80	80
<b>Case</b>	1	1	1	1
<b>80 / MIN</b>	-0.04	-1.83	-0.44	-0.06
<b>Node</b>	80	80	81	80
<b>Case</b>	1	1	1	1
<b>81 / MAX</b>	-0.03	6.15	1.34	-0.11
<b>Node</b>	81	82	81	81
<b>Case</b>	1	1	1	1
<b>81 / MIN</b>	-0.03	-8.22	-1.35	-0.11
<b>Node</b>	81	81	82	81
<b>Case</b>	1	1	1	1
<b>82 / MAX</b>	-0.02	4.50	0.68	-0.03
<b>Node</b>	82	43	82	82
<b>Case</b>	1	1	1	1
<b>82 / MIN</b>	-0.02	2.25	-0.22	-0.03
<b>Node</b>	82	82	43	82
<b>Case</b>	1	1	1	1
<b>83 / MAX</b>	0.0	-0.00	0.00	0.00
<b>Node</b>	44	44	44	44
<b>Case</b>	1	1	1	1
<b>83 / MIN</b>	0.0	-0.00	-0.01	0.00
<b>Node</b>	44	44	83	44
<b>Case</b>	1	1	1	1
<b>84 / MAX</b>	-0.24	8.26	1.28	0.62
<b>Node</b>	83	84	83	83
<b>Case</b>	1	1	1	1
<b>84 / MIN</b>	-0.24	-6.67	-1.31	0.62
<b>Node</b>	83	83	84	83
<b>Case</b>	1	1	1	1
<b>85 / MAX</b>	-0.03	1.39	0.44	0.23
<b>Node</b>	84	85	84	84
<b>Case</b>	1	1	1	1
<b>85 / MIN</b>	-0.03	-0.86	-0.46	0.23
<b>Node</b>	84	84	85	84

Bar	FX (kN)	FY (kN)	FZ (kN)	MX (kNm)
Case	1	1	1	1
86 / MAX	-0.22	8.01	1.34	0.03
Node	85	86	85	85
Case	1	1	1	1
86 / MIN	-0.22	-7.68	-1.34	0.03
Node	85	85	86	85
Case	1	1	1	1
87 / MAX	-0.01	1.17	0.45	-0.03
Node	86	87	86	86
Case	1	1	1	1
87 / MIN	-0.01	-1.08	-0.44	-0.03
Node	86	86	87	86
Case	1	1	1	1
88 / MAX	-0.20	7.84	1.34	-0.02
Node	87	88	87	87
Case	1	1	1	1
88 / MIN	-0.20	-7.86	-1.34	-0.02
Node	87	87	88	87
Case	1	1	1	1
89 / MAX	0.01	1.12	0.45	-0.00
Node	88	89	88	88
Case	1	1	1	1
89 / MIN	0.01	-1.13	-0.44	-0.00
Node	88	88	89	88
Case	1	1	1	1
90 / MAX	-0.18	7.84	1.34	-0.00
Node	89	90	89	89
Case	1	1	1	1
90 / MIN	-0.18	-7.85	-1.34	-0.00
Node	89	89	90	89
Case	1	1	1	1
91 / MAX	0.02	1.12	0.45	0.00
Node	90	91	90	90
Case	1	1	1	1
91 / MIN	0.02	-1.13	-0.44	0.00
Node	90	90	91	90
Case	1	1	1	1
92 / MAX	-0.17	7.85	1.34	0.00
Node	91	92	91	91
Case	1	1	1	1
92 / MIN	-0.17	-7.85	-1.34	0.00
Node	91	91	92	91
Case	1	1	1	1
93 / MAX	0.03	1.13	0.45	-0.00
Node	92	93	92	92
Case	1	1	1	1

Bar	FX (kN)	FY (kN)	FZ (kN)	MX (kNm)
<b>93 / MIN</b>	0.03	-1.12	-0.44	-0.00
Node	92	92	93	92
Case	1	1	1	1
<b>94 / MAX</b>	-0.17	7.85	1.34	-0.00
Node	93	94	93	93
Case	1	1	1	1
<b>94 / MIN</b>	-0.17	-7.85	-1.34	-0.00
Node	93	93	94	93
Case	1	1	1	1
<b>95 / MAX</b>	0.04	1.13	0.45	0.00
Node	94	95	94	94
Case	1	1	1	1
<b>95 / MIN</b>	0.04	-1.12	-0.44	0.00
Node	94	94	95	94
Case	1	1	1	1
<b>96 / MAX</b>	-0.16	7.87	1.34	0.01
Node	95	96	95	95
Case	1	1	1	1
<b>96 / MIN</b>	-0.16	-7.83	-1.34	0.01
Node	95	95	96	95
Case	1	1	1	1
<b>97 / MAX</b>	0.04	1.10	0.45	0.04
Node	96	97	96	96
Case	1	1	1	1
<b>97 / MIN</b>	0.04	-1.15	-0.44	0.04
Node	96	96	97	96
Case	1	1	1	1
<b>98 / MAX</b>	-0.16	7.75	1.34	0.02
Node	97	98	97	97
Case	1	1	1	1
<b>98 / MIN</b>	-0.16	-7.95	-1.34	0.02
Node	97	97	98	97
Case	1	1	1	1
<b>99 / MAX</b>	0.03	0.77	0.45	-0.12
Node	98	99	98	98
Case	1	1	1	1
<b>99 / MIN</b>	0.03	-1.48	-0.44	-0.12
Node	98	98	99	98
Case	1	1	1	1
<b>100 / MAX</b>	-0.17	6.85	1.34	-0.68
Node	99	100	99	99
Case	1	1	1	1
<b>100 / MIN</b>	-0.17	-8.85	-1.35	-0.68
Node	99	99	100	99
Case	1	1	1	1
<b>101 / MAX</b>	0.00	1.90	0.74	-1.57

Bar	FX (kN)	FY (kN)	FZ (kN)	MX (kNm)
<b>Node</b>	100	45	100	100
<b>Case</b>	1	1	1	1
<b>101 / MIN</b>	0.00	-0.35	-0.16	-1.57
<b>Node</b>	100	100	45	100
<b>Case</b>	1	1	1	1
<b>102 / MAX</b>	0.0	0.00	-0.00	0.0
<b>Node</b>	46	38	46	46
<b>Case</b>	1	1	1	1
<b>102 / MIN</b>	0.0	-0.00	-0.01	0.0
<b>Node</b>	46	46	38	46
<b>Case</b>	1	1	1	1
<b>103 / MAX</b>	0.0	3.92	1.30	0.0
<b>Node</b>	38	2	38	38
<b>Case</b>	1	1	1	1
<b>103 / MIN</b>	0.0	-3.92	-1.30	0.0
<b>Node</b>	38	38	2	38
<b>Case</b>	1	1	1	1
<b>104 / MAX</b>	0.0	0.56	0.45	0.0
<b>Node</b>	2	4	2	2
<b>Case</b>	1	1	1	1
<b>104 / MIN</b>	0.0	-0.56	-0.45	0.0
<b>Node</b>	2	2	4	2
<b>Case</b>	1	1	1	1
<b>105 / MAX</b>	0.0	4.13	1.34	0.0
<b>Node</b>	4	6	4	4
<b>Case</b>	1	1	1	1
<b>105 / MIN</b>	0.0	-4.13	-1.34	0.0
<b>Node</b>	4	4	6	4
<b>Case</b>	1	1	1	1
<b>106 / MAX</b>	0.0	0.56	0.45	0.0
<b>Node</b>	6	8	6	6
<b>Case</b>	1	1	1	1
<b>106 / MIN</b>	0.0	-0.56	-0.45	0.0
<b>Node</b>	6	6	8	6
<b>Case</b>	1	1	1	1
<b>107 / MAX</b>	0.0	4.13	1.34	0.0
<b>Node</b>	8	10	8	8
<b>Case</b>	1	1	1	1
<b>107 / MIN</b>	0.0	-4.13	-1.34	0.0
<b>Node</b>	8	8	10	8
<b>Case</b>	1	1	1	1
<b>108 / MAX</b>	0.0	0.56	0.45	0.0
<b>Node</b>	10	12	10	10
<b>Case</b>	1	1	1	1
<b>108 / MIN</b>	0.0	-0.56	-0.45	0.0
<b>Node</b>	10	10	12	10



Bar	FX (kN)	FY (kN)	FZ (kN)	MX (kNm)
Case	1	1	1	1
109 / MAX	0.0	4.13	1.34	0.0
Node	12	14	12	12
Case	1	1	1	1
109 / MIN	0.0	-4.13	-1.34	0.0
Node	12	12	14	12
Case	1	1	1	1
110 / MAX	0.0	0.56	0.45	0.0
Node	14	16	14	14
Case	1	1	1	1
110 / MIN	0.0	-0.56	-0.45	0.0
Node	14	14	16	14
Case	1	1	1	1
111 / MAX	0.0	4.13	1.34	0.0
Node	16	18	16	16
Case	1	1	1	1
111 / MIN	0.0	-4.13	-1.34	0.0
Node	16	16	18	16
Case	1	1	1	1
112 / MAX	0.0	0.56	0.45	0.0
Node	18	20	18	18
Case	1	1	1	1
112 / MIN	0.0	-0.56	-0.45	0.0
Node	18	18	20	18
Case	1	1	1	1
113 / MAX	0.0	4.13	1.34	0.0
Node	20	22	20	20
Case	1	1	1	1
113 / MIN	0.0	-4.13	-1.34	0.0
Node	20	20	22	20
Case	1	1	1	1
114 / MAX	0.0	0.56	0.45	0.0
Node	22	24	22	22
Case	1	1	1	1
114 / MIN	0.0	-0.56	-0.45	0.0
Node	22	22	24	22
Case	1	1	1	1
115 / MAX	0.0	4.13	1.34	0.0
Node	24	26	24	24
Case	1	1	1	1
115 / MIN	0.0	-4.13	-1.34	0.0
Node	24	24	26	24
Case	1	1	1	1
116 / MAX	0.0	0.56	0.45	0.0
Node	26	28	26	26
Case	1	1	1	1

Bar	FX (kN)	FY (kN)	FZ (kN)	MX (kNm)
<b>116 / MIN</b>	0.0	-0.56	-0.45	0.0
Node	26	26	28	26
Case	1	1	1	1
<b>117 / MAX</b>	0.0	4.13	1.34	0.0
Node	28	30	28	28
Case	1	1	1	1
<b>117 / MIN</b>	0.0	-4.13	-1.34	0.0
Node	28	28	30	28
Case	1	1	1	1
<b>118 / MAX</b>	0.0	0.56	0.45	0.0
Node	30	32	30	30
Case	1	1	1	1
<b>118 / MIN</b>	0.0	-0.56	-0.45	0.0
Node	30	30	32	30
Case	1	1	1	1
<b>119 / MAX</b>	0.0	4.13	1.34	0.0
Node	32	34	32	32
Case	1	1	1	1
<b>119 / MIN</b>	0.0	-4.13	-1.34	0.0
Node	32	32	34	32
Case	1	1	1	1
<b>120 / MAX</b>	0.0	0.56	0.45	0.0
Node	34	36	34	34
Case	1	1	1	1
<b>120 / MIN</b>	0.0	-0.56	-0.45	0.0
Node	34	34	36	34
Case	1	1	1	1
<b>121 / MAX</b>	-3.51	-8.41	-0.63	1.16
Node	47	47	37	37
Case	1	1	1	1
<b>121 / MIN</b>	-4.69	-10.37	-0.63	1.16
Node	37	37	37	37
Case	1	1	1	1
<b>122 / MAX</b>	-1.03	-0.31	-0.39	0.38
Node	65	65	47	47
Case	1	1	1	1
<b>122 / MIN</b>	-2.21	-2.28	-0.39	0.38
Node	47	47	47	47
Case	1	1	1	1
<b>123 / MAX</b>	1.56	8.61	-0.43	-0.40
Node	83	83	65	65
Case	1	1	1	1
<b>123 / MIN</b>	0.26	6.20	-0.43	-0.40
Node	65	65	65	65
Case	1	1	1	1
<b>124 / MAX</b>	4.39	18.64	-0.19	-1.24

Bar	FX (kN)	FY (kN)	FZ (kN)	MX (kNm)
<b>Node</b>	38	38	83	83
<b>Case</b>	1	1	1	1
<b>124 / MIN</b>	2.85	15.28	-0.19	-1.24
<b>Node</b>	83	83	83	83
<b>Case</b>	1	1	1	1
<b>125 / MAX</b>	-4.22	-11.93	0.47	0.28
<b>Node</b>	48	48	1	1
<b>Case</b>	1	1	1	1
<b>125 / MIN</b>	-5.40	-15.72	0.47	0.28
<b>Node</b>	1	1	1	1
<b>Case</b>	1	1	1	1
<b>126 / MAX</b>	-1.31	-0.14	0.30	0.11
<b>Node</b>	66	66	48	48
<b>Case</b>	1	1	1	1
<b>126 / MIN</b>	-2.49	-3.93	0.30	0.11
<b>Node</b>	48	48	48	48
<b>Case</b>	1	1	1	1
<b>127 / MAX</b>	1.73	12.20	0.33	-0.25
<b>Node</b>	84	84	66	66
<b>Case</b>	1	1	1	1
<b>127 / MIN</b>	0.43	7.68	0.33	-0.25
<b>Node</b>	66	66	66	66
<b>Case</b>	1	1	1	1
<b>128 / MAX</b>	5.01	27.35	0.12	0.06
<b>Node</b>	2	2	84	84
<b>Case</b>	1	1	1	1
<b>128 / MIN</b>	3.48	21.32	0.12	0.06
<b>Node</b>	84	84	84	84
<b>Case</b>	1	1	1	1
<b>129 / MAX</b>	-4.34	-12.14	-0.46	0.32
<b>Node</b>	49	49	3	3
<b>Case</b>	1	1	1	1
<b>129 / MIN</b>	-5.52	-15.93	-0.46	0.32
<b>Node</b>	3	3	3	3
<b>Case</b>	1	1	1	1
<b>130 / MAX</b>	-1.35	-0.30	-0.33	0.08
<b>Node</b>	67	67	49	49
<b>Case</b>	1	1	1	1
<b>130 / MIN</b>	-2.52	-4.09	-0.33	0.08
<b>Node</b>	49	49	49	49
<b>Case</b>	1	1	1	1
<b>131 / MAX</b>	1.76	12.71	-0.33	-0.09
<b>Node</b>	85	85	67	67
<b>Case</b>	1	1	1	1
<b>131 / MIN</b>	0.46	8.19	-0.33	-0.09
<b>Node</b>	67	67	67	67

Bar	FX (kN)	FY (kN)	FZ (kN)	MX (kNm)
Case	1	1	1	1
132 / MAX	5.10	27.82	-0.15	-0.37
Node	4	4	85	85
Case	1	1	1	1
132 / MIN	3.57	21.79	-0.15	-0.37
Node	85	85	85	85
Case	1	1	1	1
133 / MAX	-4.31	-12.23	0.48	-0.18
Node	50	50	5	5
Case	1	1	1	1
133 / MIN	-5.49	-16.01	0.48	-0.18
Node	5	5	5	5
Case	1	1	1	1
134 / MAX	-1.34	-0.22	0.32	-0.04
Node	68	68	50	50
Case	1	1	1	1
134 / MIN	-2.52	-4.00	0.32	-0.04
Node	50	50	50	50
Case	1	1	1	1
135 / MAX	1.75	12.83	0.34	0.00
Node	86	86	68	68
Case	1	1	1	1
135 / MIN	0.45	8.31	0.34	0.00
Node	68	68	68	68
Case	1	1	1	1
136 / MAX	5.08	27.95	0.13	0.30
Node	6	6	86	86
Case	1	1	1	1
136 / MIN	3.55	21.92	0.13	0.30
Node	86	86	86	86
Case	1	1	1	1
137 / MAX	-4.31	-12.10	-0.46	0.11
Node	51	51	7	7
Case	1	1	1	1
137 / MIN	-5.49	-15.89	-0.46	0.11
Node	7	7	7	7
Case	1	1	1	1
138 / MAX	-1.34	-0.18	-0.33	0.01
Node	69	69	51	51
Case	1	1	1	1
138 / MIN	-2.52	-3.97	-0.33	0.01
Node	51	51	51	51
Case	1	1	1	1
139 / MAX	1.76	12.76	-0.34	0.03
Node	87	87	69	69
Case	1	1	1	1

Bar	FX (kN)	FY (kN)	FZ (kN)	MX (kNm)
<b>139 / MIN</b>	0.45	8.24	-0.34	0.03
Node	69	69	69	69
Case	1	1	1	1
<b>140 / MAX</b>	5.08	27.82	-0.15	-0.25
Node	8	8	87	87
Case	1	1	1	1
<b>140 / MIN</b>	3.55	21.79	-0.15	-0.25
Node	87	87	87	87
Case	1	1	1	1
<b>141 / MAX</b>	-4.31	-12.01	0.48	-0.15
Node	52	52	9	9
Case	1	1	1	1
<b>141 / MIN</b>	-5.49	-15.80	0.48	-0.15
Node	9	9	9	9
Case	1	1	1	1
<b>142 / MAX</b>	-1.34	-0.16	0.33	-0.03
Node	70	70	52	52
Case	1	1	1	1
<b>142 / MIN</b>	-2.52	-3.95	0.33	-0.03
Node	52	52	52	52
Case	1	1	1	1
<b>143 / MAX</b>	1.75	12.67	0.34	-0.01
Node	88	88	70	70
Case	1	1	1	1
<b>143 / MIN</b>	0.45	8.15	0.34	-0.01
Node	70	70	70	70
Case	1	1	1	1
<b>144 / MAX</b>	5.08	27.68	0.13	0.28
Node	10	10	88	88
Case	1	1	1	1
<b>144 / MIN</b>	3.55	21.65	0.13	0.28
Node	88	88	88	88
Case	1	1	1	1
<b>145 / MAX</b>	-4.31	-12.01	-0.46	0.14
Node	53	53	11	11
Case	1	1	1	1
<b>145 / MIN</b>	-5.49	-15.79	-0.46	0.14
Node	11	11	11	11
Case	1	1	1	1
<b>146 / MAX</b>	-1.34	-0.16	-0.33	0.03
Node	71	71	53	53
Case	1	1	1	1
<b>146 / MIN</b>	-2.52	-3.95	-0.33	0.03
Node	53	53	53	53
Case	1	1	1	1
<b>147 / MAX</b>	1.76	12.67	-0.34	0.02

Bar	FX (kN)	FY (kN)	FZ (kN)	MX (kNm)
<b>Node</b>	89	89	71	71
<b>Case</b>	1	1	1	1
<b>147 / MIN</b>	0.45	8.15	-0.34	0.02
<b>Node</b>	71	71	71	71
<b>Case</b>	1	1	1	1
<b>148 / MAX</b>	5.08	27.67	-0.14	-0.27
<b>Node</b>	12	12	89	89
<b>Case</b>	1	1	1	1
<b>148 / MIN</b>	3.54	21.64	-0.14	-0.27
<b>Node</b>	89	89	89	89
<b>Case</b>	1	1	1	1
<b>149 / MAX</b>	-4.31	-12.01	0.48	-0.14
<b>Node</b>	54	54	13	13
<b>Case</b>	1	1	1	1
<b>149 / MIN</b>	-5.49	-15.79	0.48	-0.14
<b>Node</b>	13	13	13	13
<b>Case</b>	1	1	1	1
<b>150 / MAX</b>	-1.34	-0.16	0.33	-0.03
<b>Node</b>	72	72	54	54
<b>Case</b>	1	1	1	1
<b>150 / MIN</b>	-2.52	-3.95	0.33	-0.03
<b>Node</b>	54	54	54	54
<b>Case</b>	1	1	1	1
<b>151 / MAX</b>	1.75	12.67	0.34	-0.02
<b>Node</b>	90	90	72	72
<b>Case</b>	1	1	1	1
<b>151 / MIN</b>	0.45	8.15	0.34	-0.02
<b>Node</b>	72	72	72	72
<b>Case</b>	1	1	1	1
<b>152 / MAX</b>	5.08	27.67	0.13	0.27
<b>Node</b>	14	14	90	90
<b>Case</b>	1	1	1	1
<b>152 / MIN</b>	3.55	21.64	0.13	0.27
<b>Node</b>	90	90	90	90
<b>Case</b>	1	1	1	1
<b>153 / MAX</b>	-4.31	-12.01	-0.46	0.14
<b>Node</b>	55	55	15	15
<b>Case</b>	1	1	1	1
<b>153 / MIN</b>	-5.49	-15.80	-0.46	0.14
<b>Node</b>	15	15	15	15
<b>Case</b>	1	1	1	1
<b>154 / MAX</b>	-1.34	-0.16	-0.33	0.03
<b>Node</b>	73	73	55	55
<b>Case</b>	1	1	1	1
<b>154 / MIN</b>	-2.52	-3.95	-0.33	0.03
<b>Node</b>	55	55	55	55

Bar	FX (kN)	FY (kN)	FZ (kN)	MX (kNm)
Case	1	1	1	1
155 / MAX	1.76	12.67	-0.34	0.02
Node	91	91	73	73
Case	1	1	1	1
155 / MIN	0.45	8.15	-0.34	0.02
Node	73	73	73	73
Case	1	1	1	1
156 / MAX	5.08	27.67	-0.14	-0.27
Node	16	16	91	91
Case	1	1	1	1
156 / MIN	3.54	21.64	-0.14	-0.27
Node	91	91	91	91
Case	1	1	1	1
157 / MAX	-4.31	-12.01	0.48	-0.14
Node	56	56	17	17
Case	1	1	1	1
157 / MIN	-5.49	-15.80	0.48	-0.14
Node	17	17	17	17
Case	1	1	1	1
158 / MAX	-1.34	-0.16	0.33	-0.03
Node	74	74	56	56
Case	1	1	1	1
158 / MIN	-2.52	-3.95	0.33	-0.03
Node	56	56	56	56
Case	1	1	1	1
159 / MAX	1.75	12.67	0.34	-0.02
Node	92	92	74	74
Case	1	1	1	1
159 / MIN	0.45	8.15	0.34	-0.02
Node	74	74	74	74
Case	1	1	1	1
160 / MAX	5.08	27.67	0.14	0.27
Node	18	18	92	92
Case	1	1	1	1
160 / MIN	3.55	21.64	0.14	0.27
Node	92	92	92	92
Case	1	1	1	1
161 / MAX	-4.31	-12.01	-0.47	0.14
Node	57	57	19	19
Case	1	1	1	1
161 / MIN	-5.49	-15.80	-0.47	0.14
Node	19	19	19	19
Case	1	1	1	1
162 / MAX	-1.34	-0.16	-0.33	0.03
Node	75	75	57	57
Case	1	1	1	1

Bar	FX (kN)	FY (kN)	FZ (kN)	MX (kNm)
<b>162 / MIN</b>	-2.52	-3.95	-0.33	0.03
Node	57	57	57	57
Case	1	1	1	1
<b>163 / MAX</b>	1.76	12.67	-0.34	0.02
Node	93	93	75	75
Case	1	1	1	1
<b>163 / MIN</b>	0.45	8.15	-0.34	0.02
Node	75	75	75	75
Case	1	1	1	1
<b>164 / MAX</b>	5.08	27.67	-0.14	-0.27
Node	20	20	93	93
Case	1	1	1	1
<b>164 / MIN</b>	3.54	21.64	-0.14	-0.27
Node	93	93	93	93
Case	1	1	1	1
<b>165 / MAX</b>	-4.31	-12.00	0.48	-0.14
Node	58	58	21	21
Case	1	1	1	1
<b>165 / MIN</b>	-5.49	-15.79	0.48	-0.14
Node	21	21	21	21
Case	1	1	1	1
<b>166 / MAX</b>	-1.34	-0.16	0.33	-0.03
Node	76	76	58	58
Case	1	1	1	1
<b>166 / MIN</b>	-2.52	-3.95	0.33	-0.03
Node	58	58	58	58
Case	1	1	1	1
<b>167 / MAX</b>	1.75	12.66	0.34	-0.02
Node	94	94	76	76
Case	1	1	1	1
<b>167 / MIN</b>	0.45	8.14	0.34	-0.02
Node	76	76	76	76
Case	1	1	1	1
<b>168 / MAX</b>	5.08	27.66	0.14	0.27
Node	22	22	94	94
Case	1	1	1	1
<b>168 / MIN</b>	3.55	21.63	0.14	0.27
Node	94	94	94	94
Case	1	1	1	1
<b>169 / MAX</b>	-4.31	-12.00	-0.47	0.15
Node	59	59	23	23
Case	1	1	1	1
<b>169 / MIN</b>	-5.49	-15.78	-0.47	0.15
Node	23	23	23	23
Case	1	1	1	1
<b>170 / MAX</b>	-1.34	-0.16	-0.33	0.03



Bar	FX (kN)	FY (kN)	FZ (kN)	MX (kNm)
<b>Node</b>	77	77	59	59
<b>Case</b>	1	1	1	1
<b>170 / MIN</b>	-2.52	-3.94	-0.33	0.03
<b>Node</b>	59	59	59	59
<b>Case</b>	1	1	1	1
<b>171 / MAX</b>	1.76	12.66	-0.34	0.01
<b>Node</b>	95	95	77	77
<b>Case</b>	1	1	1	1
<b>171 / MIN</b>	0.45	8.14	-0.34	0.01
<b>Node</b>	77	77	77	77
<b>Case</b>	1	1	1	1
<b>172 / MAX</b>	5.08	27.66	-0.14	-0.27
<b>Node</b>	24	24	95	95
<b>Case</b>	1	1	1	1
<b>172 / MIN</b>	3.54	21.63	-0.14	-0.27
<b>Node</b>	95	95	95	95
<b>Case</b>	1	1	1	1
<b>173 / MAX</b>	-4.31	-12.08	0.48	-0.10
<b>Node</b>	60	60	25	25
<b>Case</b>	1	1	1	1
<b>173 / MIN</b>	-5.49	-15.86	0.48	-0.10
<b>Node</b>	25	25	25	25
<b>Case</b>	1	1	1	1
<b>174 / MAX</b>	-1.34	-0.17	0.33	-0.01
<b>Node</b>	78	78	60	60
<b>Case</b>	1	1	1	1
<b>174 / MIN</b>	-2.52	-3.96	0.33	-0.01
<b>Node</b>	60	60	60	60
<b>Case</b>	1	1	1	1
<b>175 / MAX</b>	1.75	12.74	0.34	-0.04
<b>Node</b>	96	96	78	78
<b>Case</b>	1	1	1	1
<b>175 / MIN</b>	0.45	8.22	0.34	-0.04
<b>Node</b>	78	78	78	78
<b>Case</b>	1	1	1	1
<b>176 / MAX</b>	5.08	27.79	0.14	0.25
<b>Node</b>	26	26	96	96
<b>Case</b>	1	1	1	1
<b>176 / MIN</b>	3.55	21.75	0.14	0.25
<b>Node</b>	96	96	96	96
<b>Case</b>	1	1	1	1
<b>177 / MAX</b>	-4.31	-12.21	-0.47	0.20
<b>Node</b>	61	61	27	27
<b>Case</b>	1	1	1	1
<b>177 / MIN</b>	-5.49	-16.00	-0.47	0.20
<b>Node</b>	27	27	27	27

Bar	FX (kN)	FY (kN)	FZ (kN)	MX (kNm)
Case	1	1	1	1
178 / MAX	-1.34	-0.19	-0.33	0.04
Node	79	79	61	61
Case	1	1	1	1
178 / MIN	-2.52	-3.98	-0.33	0.04
Node	61	61	61	61
Case	1	1	1	1
179 / MAX	1.76	12.83	-0.34	-0.02
Node	97	97	79	79
Case	1	1	1	1
179 / MIN	0.45	8.31	-0.34	-0.02
Node	79	79	79	79
Case	1	1	1	1
180 / MAX	5.08	27.91	-0.14	-0.30
Node	28	28	97	97
Case	1	1	1	1
180 / MIN	3.54	21.88	-0.14	-0.30
Node	97	97	97	97
Case	1	1	1	1
181 / MAX	-4.31	-12.42	0.48	-0.22
Node	62	62	29	29
Case	1	1	1	1
181 / MIN	-5.49	-16.21	0.48	-0.22
Node	29	29	29	29
Case	1	1	1	1
182 / MAX	-1.34	-0.32	0.33	-0.03
Node	80	80	62	62
Case	1	1	1	1
182 / MIN	-2.52	-4.11	0.33	-0.03
Node	62	62	62	62
Case	1	1	1	1
183 / MAX	1.75	12.98	0.34	0.03
Node	98	98	80	80
Case	1	1	1	1
183 / MIN	0.45	8.46	0.34	0.03
Node	80	80	80	80
Case	1	1	1	1
184 / MAX	5.09	28.24	0.14	0.29
Node	30	30	98	98
Case	1	1	1	1
184 / MIN	3.55	22.21	0.14	0.29
Node	98	98	98	98
Case	1	1	1	1
185 / MAX	-4.31	-12.50	-0.46	-0.10
Node	63	63	31	31
Case	1	1	1	1

Bar	FX (kN)	FY (kN)	FZ (kN)	MX (kNm)
<b>185 / MIN</b>	-5.49	-16.29	-0.46	-0.10
Node	31	31	31	31
Case	1	1	1	1
<b>186 / MAX</b>	-1.33	-0.45	-0.33	-0.02
Node	81	81	63	63
Case	1	1	1	1
<b>186 / MIN</b>	-2.51	-4.24	-0.33	-0.02
Node	63	63	63	63
Case	1	1	1	1
<b>187 / MAX</b>	1.76	12.70	-0.34	0.18
Node	99	99	81	81
Case	1	1	1	1
<b>187 / MIN</b>	0.45	8.18	-0.34	0.18
Node	81	81	81	81
Case	1	1	1	1
<b>188 / MAX</b>	5.07	28.36	-0.14	-0.18
Node	32	32	99	99
Case	1	1	1	1
<b>188 / MIN</b>	3.54	22.32	-0.14	-0.18
Node	99	99	99	99
Case	1	1	1	1
<b>189 / MAX</b>	-4.69	-8.92	0.40	-1.85
Node	64	64	33	33
Case	1	1	1	1
<b>189 / MIN</b>	-5.87	-12.71	0.40	-1.85
Node	33	33	33	33
Case	1	1	1	1
<b>190 / MAX</b>	-1.51	0.61	0.30	-0.67
Node	82	82	64	64
Case	1	1	1	1
<b>190 / MIN</b>	-2.69	-3.18	0.30	-0.67
Node	64	64	64	64
Case	1	1	1	1
<b>191 / MAX</b>	1.82	9.03	0.29	0.75
Node	100	100	82	82
Case	1	1	1	1
<b>191 / MIN</b>	0.52	4.51	0.29	0.75
Node	82	82	82	82
Case	1	1	1	1
<b>192 / MAX</b>	5.45	22.26	0.12	1.41
Node	34	34	100	100
Case	1	1	1	1
<b>192 / MIN</b>	3.91	16.23	0.12	1.41
Node	100	100	100	100
Case	1	1	1	1
<b>193 / MAX</b>	-1.76	-4.47	-0.02	-2.04

Bar	FX (kN)	FY (kN)	FZ (kN)	MX (kNm)
<b>Node</b>	41	41	35	35
<b>Case</b>	1	1	1	1
<b>193 / MIN</b>	-2.94	-6.31	-0.02	-2.04
<b>Node</b>	35	35	35	35
<b>Case</b>	1	1	1	1
<b>194 / MAX</b>	-0.35	0.15	0.01	-0.79
<b>Node</b>	43	43	41	41
<b>Case</b>	1	1	1	1
<b>194 / MIN</b>	-1.53	-1.68	0.01	-0.79
<b>Node</b>	41	41	41	41
<b>Case</b>	1	1	1	1
<b>195 / MAX</b>	1.17	6.80	-0.01	0.87
<b>Node</b>	45	45	43	43
<b>Case</b>	1	1	1	1
<b>195 / MIN</b>	-0.13	4.65	-0.01	0.87
<b>Node</b>	43	43	43	43
<b>Case</b>	1	1	1	1
<b>196 / MAX</b>	2.86	11.43	-0.00	1.45
<b>Node</b>	36	36	45	45
<b>Case</b>	1	1	1	1
<b>196 / MIN</b>	1.32	8.70	-0.00	1.45
<b>Node</b>	45	45	45	45
<b>Case</b>	1	1	1	1

Bar	MY (kNm)	MZ (kNm)
<b>26 / MAX</b>	0.00	-0.00
<b>Node</b>	39	39
<b>Case</b>	1	1
<b>26 / MIN</b>	-0.00	-0.00
<b>Node</b>	37	37
<b>Case</b>	1	1
<b>27 / MAX</b>	-0.73	1.16
<b>Node</b>	37	37
<b>Case</b>	1	1
<b>27 / MIN</b>	-0.90	-3.35
<b>Node</b>	1	1
<b>Case</b>	1	1
<b>28 / MAX</b>	-0.38	-2.45
<b>Node</b>	1	3
<b>Case</b>	1	1
<b>28 / MIN</b>	-0.40	-3.07
<b>Node</b>	3	1
<b>Case</b>	1	1
<b>29 / MAX</b>	-0.91	-2.13
<b>Node</b>	3	3

Bar	MY (kNm)	MZ (kNm)
Case	1	1
29 / MIN	-0.92	-2.32
Node	5	5
Case	1	1
30 / MAX	-0.38	-2.38
Node	5	7
Case	1	1
30 / MIN	-0.40	-2.50
Node	7	5
Case	1	1
31 / MAX	-0.91	-2.27
Node	7	7
Case	1	1
31 / MIN	-0.92	-2.27
Node	9	9
Case	1	1
32 / MAX	-0.39	-2.41
Node	9	11
Case	1	1
32 / MIN	-0.40	-2.42
Node	11	9
Case	1	1
33 / MAX	-0.91	-2.27
Node	11	11
Case	1	1
33 / MIN	-0.92	-2.27
Node	13	13
Case	1	1
34 / MAX	-0.39	-2.41
Node	13	13
Case	1	1
34 / MIN	-0.40	-2.42
Node	15	15
Case	1	1
35 / MAX	-0.91	-2.27
Node	15	17
Case	1	1
35 / MIN	-0.92	-2.27
Node	17	15
Case	1	1
36 / MAX	-0.39	-2.41
Node	17	19
Case	1	1
36 / MIN	-0.40	-2.42
Node	19	17
Case	1	1

Bar	MY (kNm)	MZ (kNm)
<b>37 / MAX</b>	-0.91	-2.27
Node	19	21
Case	1	1
<b>37 / MIN</b>	-0.92	-2.27
Node	21	19
Case	1	1
<b>38 / MAX</b>	-0.39	-2.41
Node	21	21
Case	1	1
<b>38 / MIN</b>	-0.40	-2.42
Node	23	23
Case	1	1
<b>39 / MAX</b>	-0.91	-2.27
Node	23	23
Case	1	1
<b>39 / MIN</b>	-0.92	-2.28
Node	25	25
Case	1	1
<b>40 / MAX</b>	-0.39	-2.38
Node	25	25
Case	1	1
<b>40 / MIN</b>	-0.40	-2.46
Node	27	27
Case	1	1
<b>41 / MAX</b>	-0.91	-2.25
Node	27	27
Case	1	1
<b>41 / MIN</b>	-0.92	-2.29
Node	29	29
Case	1	1
<b>42 / MAX</b>	-0.39	-2.17
Node	31	31
Case	1	1
<b>42 / MIN</b>	-0.39	-2.51
Node	29	29
Case	1	1
<b>43 / MAX</b>	-0.90	-2.27
Node	31	31
Case	1	1
<b>43 / MIN</b>	-0.95	-2.40
Node	33	33
Case	1	1
<b>44 / MAX</b>	0.04	2.04
Node	35	35
Case	1	1
<b>44 / MIN</b>	-0.52	-4.25

Bar	MY (kNm)	MZ (kNm)
Node	33	33
Case	1	1
45 / MAX	0.00	-0.00
Node	40	40
Case	1	1
45 / MIN	-0.00	-0.00
Node	47	47
Case	1	1
46 / MAX	-0.88	-0.77
Node	47	47
Case	1	1
46 / MIN	-0.90	-2.87
Node	48	48
Case	1	1
47 / MAX	-0.22	-3.04
Node	48	48
Case	1	1
47 / MIN	-0.25	-3.37
Node	49	49
Case	1	1
48 / MAX	-0.96	-3.61
Node	49	49
Case	1	1
48 / MIN	-0.97	-4.64
Node	50	50
Case	1	1
49 / MAX	-0.24	-4.51
Node	50	50
Case	1	1
49 / MIN	-0.25	-4.61
Node	51	51
Case	1	1
50 / MAX	-0.96	-4.69
Node	51	52
Case	1	1
50 / MIN	-0.97	-4.71
Node	52	51
Case	1	1
51 / MAX	-0.24	-4.55
Node	52	53
Case	1	1
51 / MIN	-0.25	-4.56
Node	53	52
Case	1	1
52 / MAX	-0.96	-4.64
Node	53	54

Bar	MY (kNm)	MZ (kNm)
Case	1	1
52 / MIN	-0.97	-4.67
Node	54	53
Case	1	1
53 / MAX	-0.24	-4.52
Node	54	55
Case	1	1
53 / MIN	-0.25	-4.53
Node	55	54
Case	1	1
54 / MAX	-0.96	-4.64
Node	55	56
Case	1	1
54 / MIN	-0.97	-4.64
Node	56	55
Case	1	1
55 / MAX	-0.24	-4.52
Node	56	56
Case	1	1
55 / MIN	-0.24	-4.52
Node	57	57
Case	1	1
56 / MAX	-0.96	-4.64
Node	57	57
Case	1	1
56 / MIN	-0.97	-4.66
Node	58	58
Case	1	1
57 / MAX	-0.24	-4.54
Node	58	58
Case	1	1
57 / MIN	-0.24	-4.56
Node	59	59
Case	1	1
58 / MAX	-0.96	-4.68
Node	59	59
Case	1	1
58 / MIN	-0.97	-4.77
Node	60	60
Case	1	1
59 / MAX	-0.24	-4.63
Node	60	61
Case	1	1
59 / MIN	-0.24	-4.68
Node	61	60
Case	1	1



Bar	MY (kNm)	MZ (kNm)
<b>60 / MAX</b>	-0.96	-3.87
Node	61	62
Case	1	1
<b>60 / MIN</b>	-0.97	-4.79
Node	62	61
Case	1	1
<b>61 / MAX</b>	-0.24	-2.99
Node	62	63
Case	1	1
<b>61 / MIN</b>	-0.24	-3.67
Node	63	62
Case	1	1
<b>62 / MAX</b>	-0.96	0.06
Node	63	64
Case	1	1
<b>62 / MIN</b>	-0.97	-2.91
Node	64	63
Case	1	1
<b>63 / MAX</b>	-0.01	1.24
Node	41	64
Case	1	1
<b>63 / MIN</b>	-0.33	-1.25
Node	64	41
Case	1	1
<b>64 / MAX</b>	0.00	0.00
Node	42	65
Case	1	1
<b>64 / MIN</b>	-0.00	-0.00
Node	65	42
Case	1	1
<b>65 / MAX</b>	-0.85	-0.79
Node	65	65
Case	1	1
<b>65 / MIN</b>	-0.90	-2.25
Node	66	66
Case	1	1
<b>66 / MAX</b>	-0.25	-2.62
Node	66	66
Case	1	1
<b>66 / MIN</b>	-0.27	-3.35
Node	67	67
Case	1	1
<b>67 / MAX</b>	-0.96	-3.52
Node	68	67
Case	1	1
<b>67 / MIN</b>	-0.96	-4.91

Bar	MY (kNm)	MZ (kNm)
Node	67	68
Case	1	1
<b>68 / MAX</b>	-0.27	-4.86
Node	69	68
Case	1	1
<b>68 / MIN</b>	-0.27	-5.01
Node	68	69
Case	1	1
<b>69 / MAX</b>	-0.96	-4.95
Node	70	70
Case	1	1
<b>69 / MIN</b>	-0.96	-4.99
Node	69	69
Case	1	1
<b>70 / MAX</b>	-0.27	-4.91
Node	71	71
Case	1	1
<b>70 / MIN</b>	-0.27	-4.93
Node	70	70
Case	1	1
<b>71 / MAX</b>	-0.96	-4.89
Node	72	72
Case	1	1
<b>71 / MIN</b>	-0.96	-4.92
Node	71	71
Case	1	1
<b>72 / MAX</b>	-0.27	-4.88
Node	73	73
Case	1	1
<b>72 / MIN</b>	-0.27	-4.88
Node	72	72
Case	1	1
<b>73 / MAX</b>	-0.96	-4.88
Node	74	74
Case	1	1
<b>73 / MIN</b>	-0.96	-4.89
Node	73	73
Case	1	1
<b>74 / MAX</b>	-0.27	-4.87
Node	75	74
Case	1	1
<b>74 / MIN</b>	-0.27	-4.88
Node	74	75
Case	1	1
<b>75 / MAX</b>	-0.96	-4.88
Node	76	75

Bar	MY (kNm)	MZ (kNm)
Case	1	1
75 / MIN	-0.96	-4.91
Node	75	76
Case	1	1
76 / MAX	-0.27	-4.90
Node	77	76
Case	1	1
76 / MIN	-0.27	-4.92
Node	76	77
Case	1	1
77 / MAX	-0.96	-4.94
Node	78	77
Case	1	1
77 / MIN	-0.96	-5.06
Node	77	78
Case	1	1
78 / MAX	-0.27	-5.01
Node	79	79
Case	1	1
78 / MIN	-0.27	-5.09
Node	78	78
Case	1	1
79 / MAX	-0.96	-3.99
Node	80	80
Case	1	1
79 / MIN	-0.96	-5.07
Node	79	79
Case	1	1
80 / MAX	-0.26	-2.86
Node	81	81
Case	1	1
80 / MIN	-0.27	-3.92
Node	80	80
Case	1	1
81 / MAX	-0.95	1.99
Node	81	82
Case	1	1
81 / MIN	-0.97	-2.66
Node	82	81
Case	1	1
82 / MAX	-0.01	3.40
Node	43	82
Case	1	1
82 / MIN	-0.35	-1.66
Node	82	43
Case	1	1

Bar	MY (kNm)	MZ (kNm)
<b>83 / MAX</b>	-0.00	0.00
Node	44	83
Case	1	1
<b>83 / MIN</b>	-0.00	0.00
Node	83	44
Case	1	1
<b>84 / MAX</b>	-0.82	-0.84
Node	83	83
Case	1	1
<b>84 / MIN</b>	-0.89	-4.29
Node	84	84
Case	1	1
<b>85 / MAX</b>	-0.30	-3.98
Node	84	84
Case	1	1
<b>85 / MIN</b>	-0.32	-4.38
Node	85	85
Case	1	1
<b>86 / MAX</b>	-0.94	-4.67
Node	86	85
Case	1	1
<b>86 / MIN</b>	-0.94	-5.41
Node	85	86
Case	1	1
<b>87 / MAX</b>	-0.31	-5.11
Node	87	86
Case	1	1
<b>87 / MIN</b>	-0.32	-5.19
Node	86	87
Case	1	1
<b>88 / MAX</b>	-0.94	-5.43
Node	88	88
Case	1	1
<b>88 / MIN</b>	-0.94	-5.47
Node	87	87
Case	1	1
<b>89 / MAX</b>	-0.31	-5.13
Node	89	89
Case	1	1
<b>89 / MIN</b>	-0.32	-5.14
Node	88	88
Case	1	1
<b>90 / MAX</b>	-0.94	-5.40
Node	90	90
Case	1	1
<b>90 / MIN</b>	-0.94	-5.42

Bar	MY (kNm)	MZ (kNm)
Node	89	89
Case	1	1
<b>91 / MAX</b>	-0.31	-5.11
Node	91	91
Case	1	1
<b>91 / MIN</b>	-0.32	-5.11
Node	90	90
Case	1	1
<b>92 / MAX</b>	-0.94	-5.40
Node	92	92
Case	1	1
<b>92 / MIN</b>	-0.94	-5.40
Node	91	91
Case	1	1
<b>93 / MAX</b>	-0.31	-5.11
Node	93	92
Case	1	1
<b>93 / MIN</b>	-0.32	-5.11
Node	92	93
Case	1	1
<b>94 / MAX</b>	-0.94	-5.40
Node	94	93
Case	1	1
<b>94 / MIN</b>	-0.94	-5.41
Node	93	94
Case	1	1
<b>95 / MAX</b>	-0.31	-5.12
Node	95	94
Case	1	1
<b>95 / MIN</b>	-0.32	-5.14
Node	94	95
Case	1	1
<b>96 / MAX</b>	-0.94	-5.42
Node	96	95
Case	1	1
<b>96 / MIN</b>	-0.94	-5.50
Node	95	96
Case	1	1
<b>97 / MAX</b>	-0.31	-5.18
Node	97	97
Case	1	1
<b>97 / MIN</b>	-0.32	-5.22
Node	96	96
Case	1	1
<b>98 / MAX</b>	-0.94	-5.02
Node	98	98

Bar	MY (kNm)	MZ (kNm)
Case	1	1
98 / MIN	-0.94	-5.47
Node	97	97
Case	1	1
99 / MAX	-0.31	-4.23
Node	99	99
Case	1	1
99 / MIN	-0.32	-4.76
Node	98	98
Case	1	1
100 / MAX	-0.93	-0.08
Node	99	100
Case	1	1
100 / MIN	-0.96	-4.59
Node	100	99
Case	1	1
101 / MAX	0.02	0.58
Node	45	100
Case	1	1
101 / MIN	-0.42	-0.58
Node	100	45
Case	1	1
102 / MAX	0.00	0.00
Node	46	46
Case	1	1
102 / MIN	-0.00	-0.00
Node	38	38
Case	1	1
103 / MAX	-0.94	-3.43
Node	38	2
Case	1	1
103 / MIN	-0.94	-3.43
Node	38	38
Case	1	1
104 / MAX	-0.11	-0.18
Node	2	4
Case	1	1
104 / MIN	-0.11	-0.18
Node	2	2
Case	1	1
105 / MAX	-1.01	-3.75
Node	4	6
Case	1	1
105 / MIN	-1.01	-3.75
Node	4	4
Case	1	1

Bar	MY (kNm)	MZ (kNm)
<b>106 / MAX</b>	-0.11	-0.18
Node	6	8
Case	1	1
<b>106 / MIN</b>	-0.11	-0.18
Node	6	6
Case	1	1
<b>107 / MAX</b>	-1.01	-3.75
Node	8	10
Case	1	1
<b>107 / MIN</b>	-1.01	-3.75
Node	8	8
Case	1	1
<b>108 / MAX</b>	-0.11	-0.18
Node	10	12
Case	1	1
<b>108 / MIN</b>	-0.11	-0.18
Node	10	10
Case	1	1
<b>109 / MAX</b>	-1.01	-3.75
Node	12	12
Case	1	1
<b>109 / MIN</b>	-1.01	-3.75
Node	12	12
Case	1	1
<b>110 / MAX</b>	-0.11	-0.18
Node	14	16
Case	1	1
<b>110 / MIN</b>	-0.11	-0.18
Node	14	14
Case	1	1
<b>111 / MAX</b>	-1.01	-3.75
Node	16	18
Case	1	1
<b>111 / MIN</b>	-1.01	-3.75
Node	16	16
Case	1	1
<b>112 / MAX</b>	-0.11	-0.18
Node	18	20
Case	1	1
<b>112 / MIN</b>	-0.11	-0.18
Node	18	18
Case	1	1
<b>113 / MAX</b>	-1.01	-3.75
Node	20	22
Case	1	1
<b>113 / MIN</b>	-1.01	-3.75

Bar	MY (kNm)	MZ (kNm)
Node	20	20
Case	1	1
114 / MAX	-0.11	-0.18
Node	22	24
Case	1	1
114 / MIN	-0.11	-0.18
Node	22	22
Case	1	1
115 / MAX	-1.01	-3.75
Node	24	26
Case	1	1
115 / MIN	-1.01	-3.75
Node	24	24
Case	1	1
116 / MAX	-0.11	-0.18
Node	26	28
Case	1	1
116 / MIN	-0.11	-0.18
Node	26	26
Case	1	1
117 / MAX	-1.01	-3.75
Node	28	30
Case	1	1
117 / MIN	-1.01	-3.75
Node	28	28
Case	1	1
118 / MAX	-0.11	-0.18
Node	30	32
Case	1	1
118 / MIN	-0.11	-0.18
Node	30	30
Case	1	1
119 / MAX	-1.01	-3.75
Node	32	34
Case	1	1
119 / MIN	-1.01	-3.75
Node	32	32
Case	1	1
120 / MAX	-0.11	-0.18
Node	34	36
Case	1	1
120 / MIN	-0.11	-0.18
Node	34	34
Case	1	1
121 / MAX	0.73	19.43
Node	37	47



Bar	MY (kNm)	MZ (kNm)
Case	1	1
121 / MIN	-0.51	0.89
Node	47	37
Case	1	1
122 / MAX	0.37	22.58
Node	47	65
Case	1	1
122 / MIN	-0.41	20.02
Node	65	47
Case	1	1
123 / MAX	0.44	22.51
Node	65	65
Case	1	1
123 / MIN	-0.49	6.36
Node	83	83
Case	1	1
124 / MAX	0.33	5.74
Node	83	83
Case	1	1
124 / MIN	-0.17	-37.84
Node	38	38
Case	1	1
125 / MAX	0.40	26.75
Node	48	48
Case	1	1
125 / MIN	-0.52	-0.55
Node	1	1
Case	1	1
126 / MAX	0.31	30.39
Node	66	66
Case	1	1
126 / MIN	-0.28	26.38
Node	48	48
Case	1	1
127 / MAX	0.38	30.41
Node	84	66
Case	1	1
127 / MIN	-0.34	8.74
Node	66	84
Case	1	1
128 / MAX	0.10	9.13
Node	2	84
Case	1	1
128 / MIN	-0.22	-53.41
Node	84	2
Case	1	1

Bar	MY (kNm)	MZ (kNm)
<b>129 / MAX</b>	0.51	27.44
Node	3	49
Case	1	1
<b>129 / MIN</b>	-0.39	-0.29
Node	49	3
Case	1	1
<b>130 / MAX</b>	0.32	31.58
Node	49	67
Case	1	1
<b>130 / MIN</b>	-0.34	27.24
Node	67	49
Case	1	1
<b>131 / MAX</b>	0.35	31.62
Node	67	67
Case	1	1
<b>131 / MIN</b>	-0.38	8.83
Node	85	85
Case	1	1
<b>132 / MAX</b>	0.25	9.04
Node	85	85
Case	1	1
<b>132 / MIN</b>	-0.13	-54.71
Node	4	4
Case	1	1
<b>133 / MAX</b>	0.42	27.80
Node	50	50
Case	1	1
<b>133 / MIN</b>	-0.53	-0.08
Node	5	5
Case	1	1
<b>134 / MAX</b>	0.33	31.92
Node	68	68
Case	1	1
<b>134 / MIN</b>	-0.31	27.75
Node	50	50
Case	1	1
<b>135 / MAX</b>	0.39	31.93
Node	86	68
Case	1	1
<b>135 / MIN</b>	-0.36	8.89
Node	68	86
Case	1	1
<b>136 / MAX</b>	0.11	8.95
Node	6	86
Case	1	1
<b>136 / MIN</b>	-0.23	-55.13

Bar	MY (kNm)	MZ (kNm)
Node	86	6
Case	1	1
137 / MAX	0.51	27.66
Node	7	51
Case	1	1
137 / MIN	-0.40	0.01
Node	51	7
Case	1	1
138 / MAX	0.32	31.76
Node	51	69
Case	1	1
138 / MIN	-0.34	27.67
Node	69	51
Case	1	1
139 / MAX	0.35	31.76
Node	69	69
Case	1	1
139 / MIN	-0.38	8.88
Node	87	87
Case	1	1
140 / MAX	0.25	8.87
Node	87	87
Case	1	1
140 / MIN	-0.13	-54.88
Node	8	8
Case	1	1
141 / MAX	0.42	27.48
Node	52	52
Case	1	1
141 / MIN	-0.53	0.01
Node	9	9
Case	1	1
142 / MAX	0.33	31.54
Node	70	70
Case	1	1
142 / MIN	-0.31	27.49
Node	52	52
Case	1	1
143 / MAX	0.39	31.54
Node	88	70
Case	1	1
143 / MIN	-0.36	8.83
Node	70	88
Case	1	1
144 / MAX	0.11	8.82
Node	10	88

Bar	MY (kNm)	MZ (kNm)
Case	1	1
144 / MIN	-0.23	-54.56
Node	88	10
Case	1	1
145 / MAX	0.51	27.46
Node	11	53
Case	1	1
145 / MIN	-0.40	0.01
Node	53	11
Case	1	1
146 / MAX	0.32	31.52
Node	53	71
Case	1	1
146 / MIN	-0.34	27.46
Node	71	53
Case	1	1
147 / MAX	0.35	31.52
Node	71	71
Case	1	1
147 / MIN	-0.38	8.83
Node	89	89
Case	1	1
148 / MAX	0.24	8.83
Node	89	89
Case	1	1
148 / MIN	-0.13	-54.53
Node	12	12
Case	1	1
149 / MAX	0.42	27.46
Node	54	54
Case	1	1
149 / MIN	-0.53	0.00
Node	13	13
Case	1	1
150 / MAX	0.33	31.51
Node	72	72
Case	1	1
150 / MIN	-0.31	27.46
Node	54	54
Case	1	1
151 / MAX	0.39	31.51
Node	90	72
Case	1	1
151 / MIN	-0.35	8.83
Node	72	90
Case	1	1

Bar	MY (kNm)	MZ (kNm)
<b>152 / MAX</b>	0.11	8.83
Node	14	90
Case	1	1
<b>152 / MIN</b>	-0.23	-54.53
Node	90	14
Case	1	1
<b>153 / MAX</b>	0.52	27.46
Node	15	55
Case	1	1
<b>153 / MIN</b>	-0.40	-0.00
Node	55	15
Case	1	1
<b>154 / MAX</b>	0.32	31.52
Node	55	73
Case	1	1
<b>154 / MIN</b>	-0.34	27.46
Node	73	55
Case	1	1
<b>155 / MAX</b>	0.35	31.52
Node	73	73
Case	1	1
<b>155 / MIN</b>	-0.39	8.83
Node	91	91
Case	1	1
<b>156 / MAX</b>	0.24	8.83
Node	91	91
Case	1	1
<b>156 / MIN</b>	-0.12	-54.54
Node	16	16
Case	1	1
<b>157 / MAX</b>	0.42	27.46
Node	56	56
Case	1	1
<b>157 / MIN</b>	-0.53	-0.00
Node	17	17
Case	1	1
<b>158 / MAX</b>	0.33	31.52
Node	74	74
Case	1	1
<b>158 / MIN</b>	-0.31	27.46
Node	56	56
Case	1	1
<b>159 / MAX</b>	0.39	31.52
Node	92	74
Case	1	1
<b>159 / MIN</b>	-0.35	8.83

Bar	MY (kNm)	MZ (kNm)
Node	74	92
Case	1	1
<b>160 / MAX</b>	0.11	8.83
Node	18	92
Case	1	1
<b>160 / MIN</b>	-0.23	-54.54
Node	92	18
Case	1	1
<b>161 / MAX</b>	0.52	27.46
Node	19	57
Case	1	1
<b>161 / MIN</b>	-0.40	0.00
Node	57	19
Case	1	1
<b>162 / MAX</b>	0.32	31.51
Node	57	75
Case	1	1
<b>162 / MIN</b>	-0.34	27.46
Node	75	57
Case	1	1
<b>163 / MAX</b>	0.35	31.51
Node	75	75
Case	1	1
<b>163 / MIN</b>	-0.39	8.83
Node	93	93
Case	1	1
<b>164 / MAX</b>	0.24	8.83
Node	93	93
Case	1	1
<b>164 / MIN</b>	-0.12	-54.53
Node	20	20
Case	1	1
<b>165 / MAX</b>	0.41	27.45
Node	58	58
Case	1	1
<b>165 / MIN</b>	-0.53	0.00
Node	21	21
Case	1	1
<b>166 / MAX</b>	0.33	31.50
Node	76	76
Case	1	1
<b>166 / MIN</b>	-0.31	27.45
Node	58	58
Case	1	1
<b>167 / MAX</b>	0.39	31.50
Node	94	76

Bar	MY (kNm)	MZ (kNm)
Case	1	1
167 / MIN	-0.35	8.83
Node	76	94
Case	1	1
168 / MAX	0.12	8.82
Node	22	94
Case	1	1
168 / MIN	-0.24	-54.51
Node	94	22
Case	1	1
169 / MAX	0.52	27.45
Node	23	59
Case	1	1
169 / MIN	-0.40	0.02
Node	59	23
Case	1	1
170 / MAX	0.32	31.51
Node	59	77
Case	1	1
170 / MIN	-0.33	27.46
Node	77	59
Case	1	1
171 / MAX	0.36	31.51
Node	77	77
Case	1	1
171 / MIN	-0.39	8.83
Node	95	95
Case	1	1
172 / MAX	0.24	8.82
Node	95	95
Case	1	1
172 / MIN	-0.12	-54.52
Node	24	24
Case	1	1
173 / MAX	0.41	27.62
Node	60	60
Case	1	1
173 / MIN	-0.53	0.03
Node	25	25
Case	1	1
174 / MAX	0.34	31.72
Node	78	78
Case	1	1
174 / MIN	-0.31	27.65
Node	60	60
Case	1	1

Bar	MY (kNm)	MZ (kNm)
<b>175 / MAX</b>	0.38	31.72
Node	96	78
Case	1	1
<b>175 / MIN</b>	-0.35	8.87
Node	78	96
Case	1	1
<b>176 / MAX</b>	0.12	8.85
Node	26	96
Case	1	1
<b>176 / MIN</b>	-0.24	-54.81
Node	96	26
Case	1	1
<b>177 / MAX</b>	0.52	27.82
Node	27	61
Case	1	1
<b>177 / MIN</b>	-0.40	-0.03
Node	61	27
Case	1	1
<b>178 / MAX</b>	0.32	31.92
Node	61	79
Case	1	1
<b>178 / MIN</b>	-0.33	27.80
Node	79	61
Case	1	1
<b>179 / MAX</b>	0.36	31.93
Node	79	79
Case	1	1
<b>179 / MIN</b>	-0.39	8.88
Node	97	97
Case	1	1
<b>180 / MAX</b>	0.24	8.90
Node	97	97
Case	1	1
<b>180 / MIN</b>	-0.12	-55.09
Node	28	28
Case	1	1
<b>181 / MAX</b>	0.41	28.03
Node	62	62
Case	1	1
<b>181 / MIN</b>	-0.53	-0.24
Node	29	29
Case	1	1
<b>182 / MAX</b>	0.34	32.28
Node	80	80
Case	1	1
<b>182 / MIN</b>	-0.31	27.90



Bar	MY (kNm)	MZ (kNm)
Node	62	62
Case	1	1
183 / MAX	0.38	32.34
Node	98	80
Case	1	1
183 / MIN	-0.35	8.97
Node	80	98
Case	1	1
184 / MAX	0.12	9.12
Node	30	98
Case	1	1
184 / MIN	-0.24	-55.71
Node	98	30
Case	1	1
185 / MAX	0.51	27.67
Node	31	63
Case	1	1
185 / MIN	-0.40	-0.76
Node	63	31
Case	1	1
186 / MAX	0.32	31.77
Node	63	81
Case	1	1
186 / MIN	-0.33	27.14
Node	81	63
Case	1	1
187 / MAX	0.36	31.82
Node	81	81
Case	1	1
187 / MIN	-0.39	9.06
Node	99	99
Case	1	1
188 / MAX	0.24	9.62
Node	99	99
Case	1	1
188 / MIN	-0.12	-55.50
Node	32	32
Case	1	1
189 / MAX	0.36	20.20
Node	64	64
Case	1	1
189 / MIN	-0.43	-1.16
Node	33	33
Case	1	1
190 / MAX	0.30	21.88
Node	82	82

Bar	MY (kNm)	MZ (kNm)
Case	1	1
190 / MIN	-0.29	19.34
Node	64	64
Case	1	1
191 / MAX	0.33	21.79
Node	100	82
Case	1	1
191 / MIN	-0.31	7.03
Node	82	100
Case	1	1
192 / MAX	0.10	7.92
Node	34	100
Case	1	1
192 / MIN	-0.20	-41.54
Node	100	34
Case	1	1
193 / MAX	0.04	12.78
Node	35	41
Case	1	1
193 / MIN	-0.01	2.14
Node	41	35
Case	1	1
194 / MAX	0.01	15.80
Node	43	43
Case	1	1
194 / MIN	-0.02	14.29
Node	41	41
Case	1	1
195 / MAX	0.00	15.77
Node	43	43
Case	1	1
195 / MIN	-0.01	3.29
Node	45	45
Case	1	1
196 / MAX	0.01	1.72
Node	45	45
Case	1	1
196 / MIN	-0.00	-24.15
Node	36	36
Case	1	1